

MANGUSTA OCEANO 60

MANGUSTA
Dream shapers.

MANGUSTA

WHEN EVERYWHERE

IS NOT ENOUGH







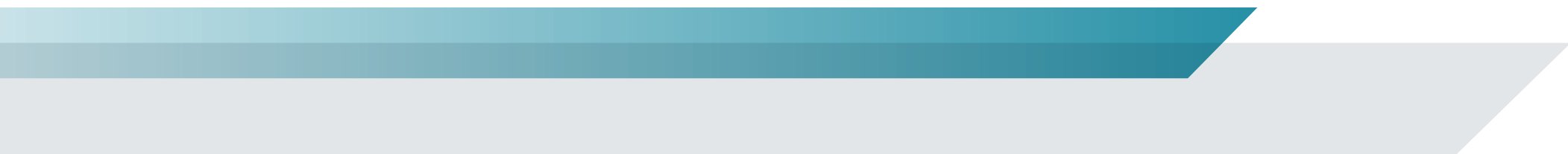



















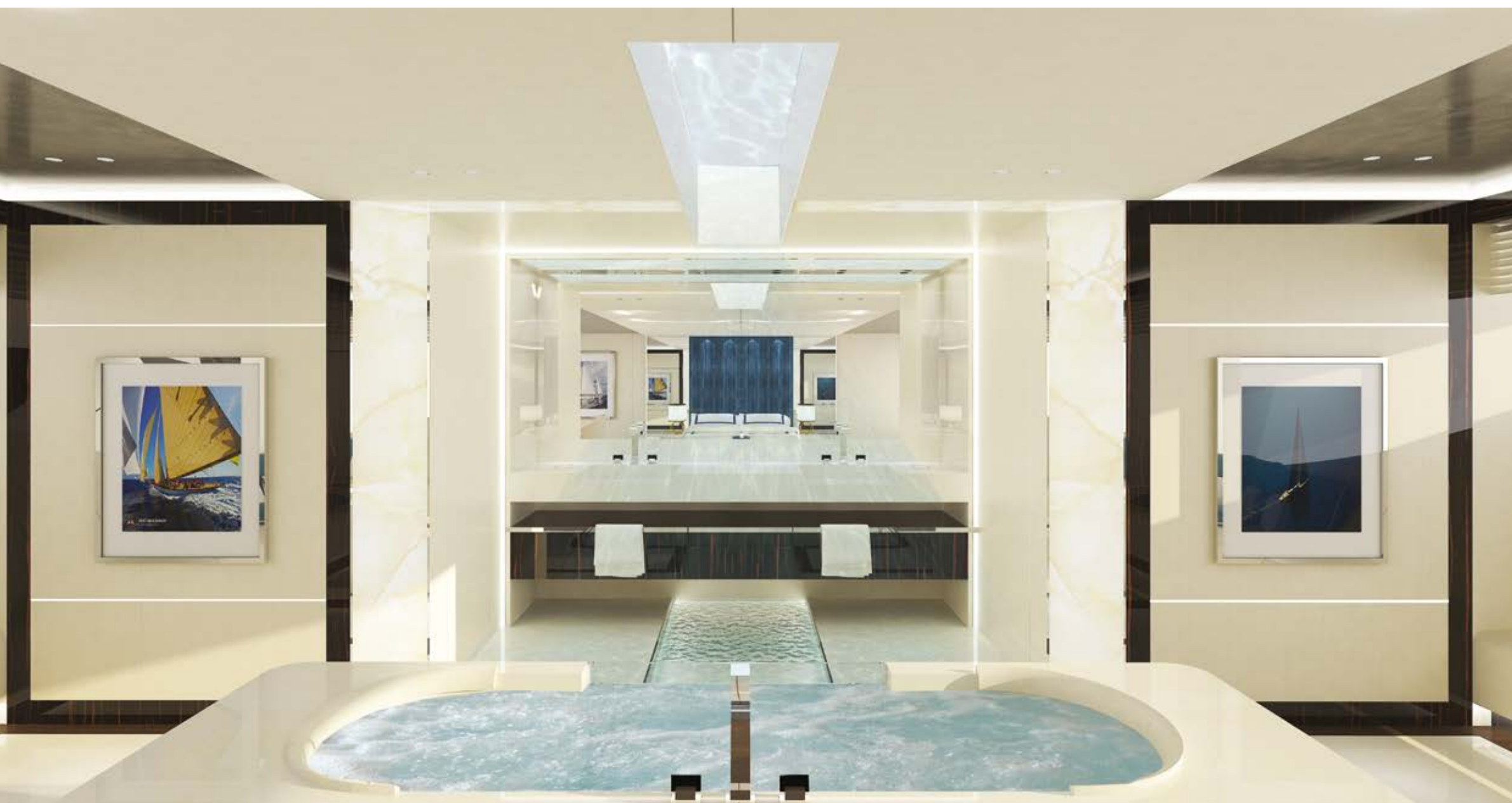

TECHNICAL SPECIFICATIONS MANGUSTA OCEANO 60

CONSTRUCTION

HULL	STEEL
SUPERSTRUCTURE	ALUMINIUM

DIMENSIONS

LENGTH OVERALL	~ 196' 10"	60 M
BEAM	~ 34' 5"	10.50 M
MAX DRAFT	~ 10' 2"	3.1 M
DISPLACEMENT AT FULL LOAD	1,763,679 LBS	800 T
GROSS TONNAGE	950 GT	

TANK CAPACITY

FUEL CAPACITY	~ 26,417 US GALS	100,000 L
WATER CAPACITY	~ 5,283 US GALS	20,000 L

PROPULSION

MAIN ENGINES POWER	2 X MTU 12V 4000 M73 2572 @ 1970 RPM (1920 kW)
--------------------	---

STABILIZERS	ZERO SPEED AND UNDERWAY
-------------	-------------------------

PERFORMANCE

MAX SPEED HALF LOAD	~ 17 KNOTS
RANGE AT ECONOMICAL CRUISING SPEED	~ 5,000 NAUTICAL MILES

ACCOMMODATION

GUESTS	UP TO 12 IN 5 CABINS
CREW	14 IN 8 CABINS

DESIGNERS

EXTERIORS	ALBERTO MANCINI / OVERMARINE GROUP
INTERIORS	CUSTOM BUILT BESPOKE INTERIORS

CUSTOM IS KEY.

THE LAYOUT



All information contained herein, including technical and performance data, technical layouts, images and graphic reproductions is provided solely by way of information.
All technical and/or descriptive information only refers to the features of the yacht shown in this brochure.
Consequently any binding information which is the seller's responsibility will be provided exclusively in the bill of sale and specific manual.

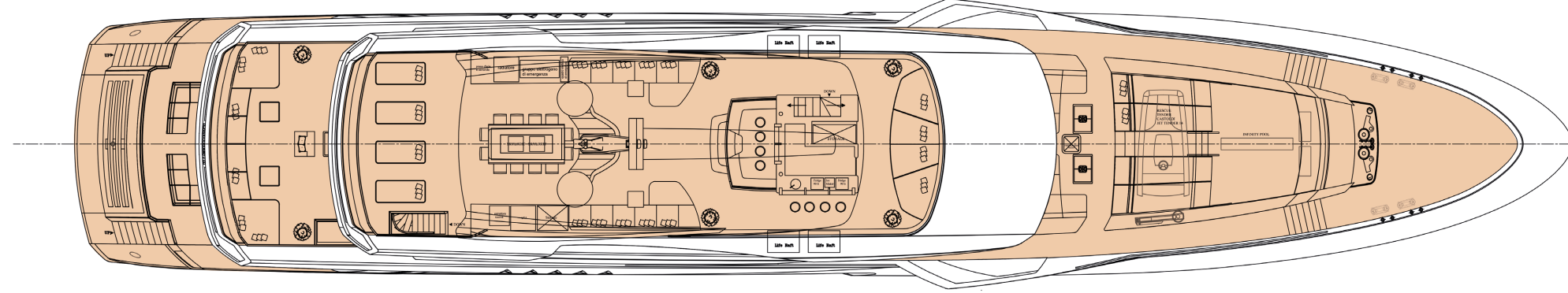

FLY DECK

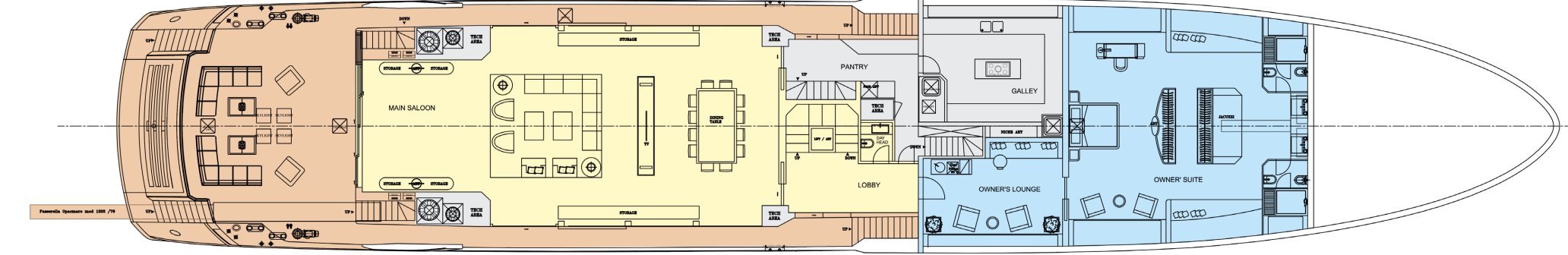

- MAIN SALOON & LOBBY
- OWNER'S SUITE
- SERVICE AREA

MAIN DECK

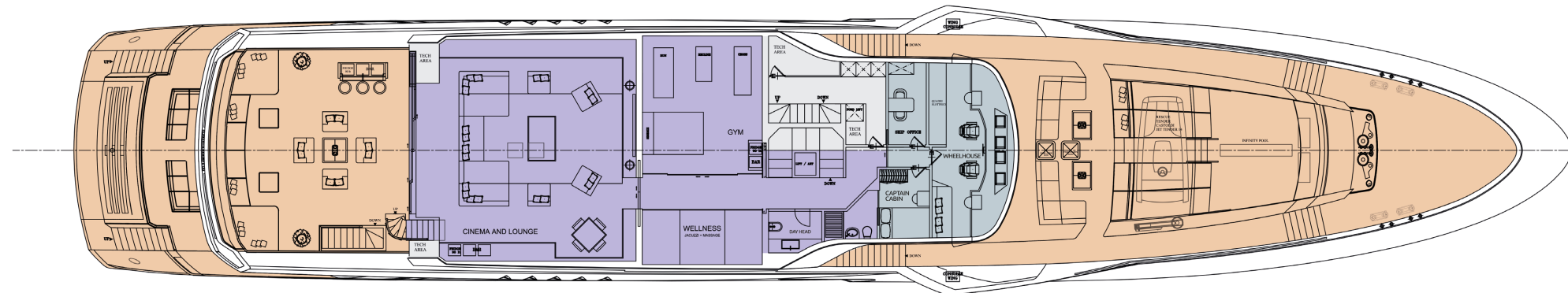

- UPPER DECK SALOON & WELLNESS
- CAPTAIN AREA
- SERVICE AREA

UPPER DECK

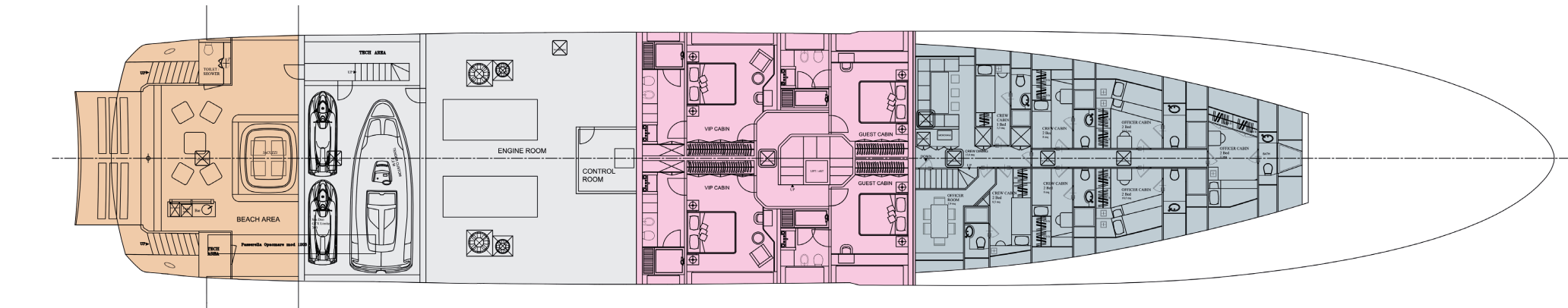

- GUEST AREA
- SERVICE AREA
- CREW AREA

LOWER DECK

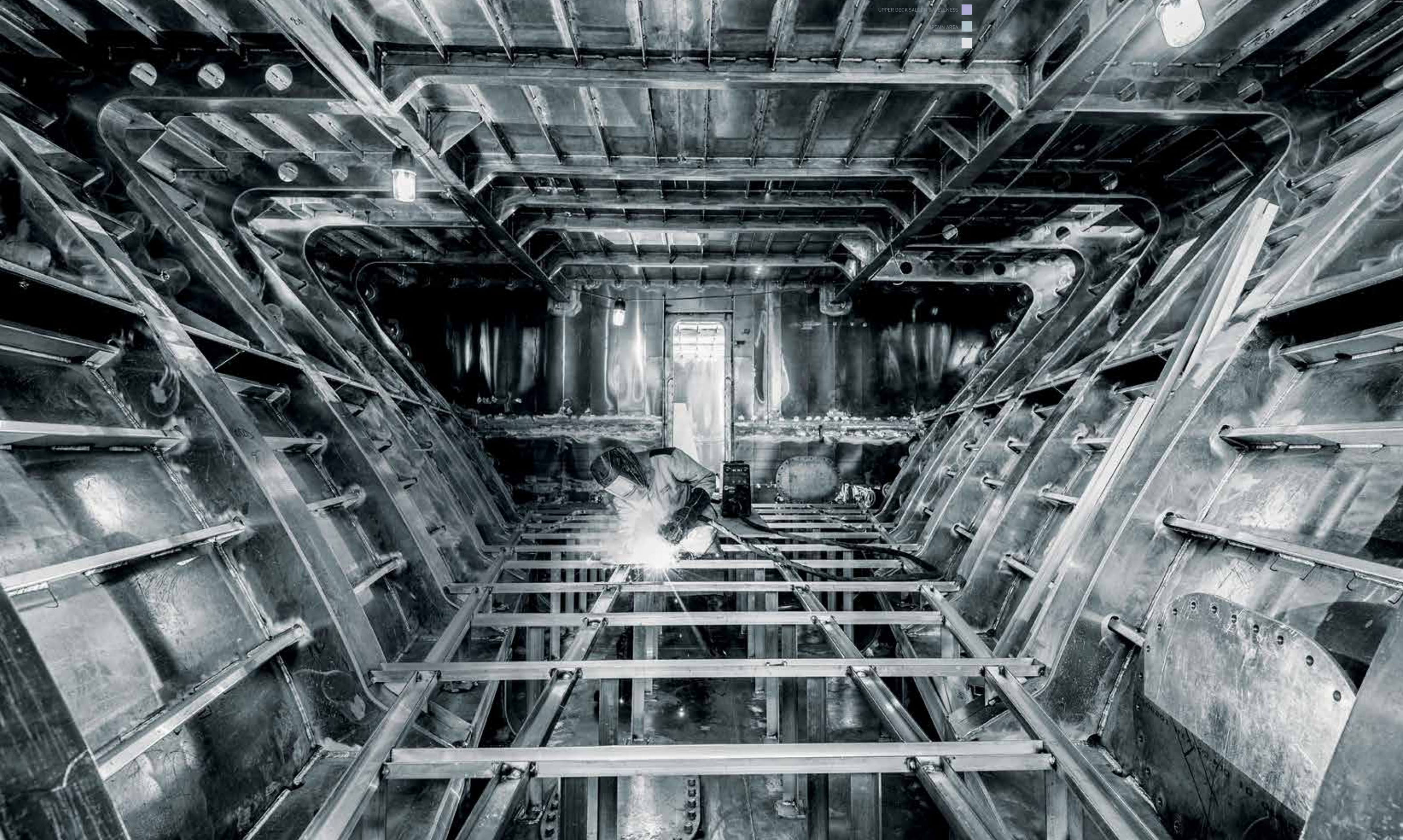

UPPER DECK SALON
CAPTAIN AREA
CABIN



MANGUSTA OCEANO
43 | 46 | 50 | 55 | 60

