

SAN REMO



SEEK

*We believe that to stop seeking
in life is to stop living.*

*Which is why we never let the sun set
without knowing we looked for more.*

The most innovative design.

Exhilarating engineering.

Jaw-dropping performance.

Breathtaking attention to detail.

*Awe-inspiring motoryachts to make the
heart race and the soul sing.*

*By daring to go where others don't, we'll
take you to places others only dream of.*

*To do this, we constantly
seek perfection.*

*And then, when we think
we've found it?*

We seek more.

MORE



CONTENTS

Introduction	04
Heritage	06
Design & Innovation	08
100 over 100FT	10
Craftsmanship	12
Individuality	14
San Remo	16
General Arrangements	22
Specifications	24
Awards & Achievements	26
Acknowledgements	27



SEEKING A DREAM, MAKING A WORLD

In 1969, Robert and John Braithwaite were two brothers with a dream – to create a boat to surpass anything made before.

That same year, the Braithwaites built the first Sunseeker. It was the seed of a whole new world.

Steadily and surely, the brothers grew their business from their small shipyard in Poole on the south coast of England.

Always seeking better boat building techniques, each craft became more ambitious, more creative – and consequently more successful – than the last.

Now, 50 years on, Sunseeker International has over 80 dealerships networked around the world, delivering over 150 boats a year globally.



EXCELLENCE. ALWAYS

When the Braithwaite brothers started up the engine of a small, open-cockpit speedboat in 1969, it wasn't just the Hostess 17 that roared into life. It was a new standard of yacht making.

Today, their passion to exceed boundaries is as strong as ever before, brought to life by a team of over 2,000 highly skilled designers, engineers and master craftsmen.

Bold new creations like the 155 Yacht keep us pushing our standards ever further, year upon year.

Just as we have always done.

The flagship 155 Yacht is the epitome of our tireless precision and attention to detail. It is this ceaseless desire to always excel in every detail that gives every Sunseeker its vital presence, performance and luxury.

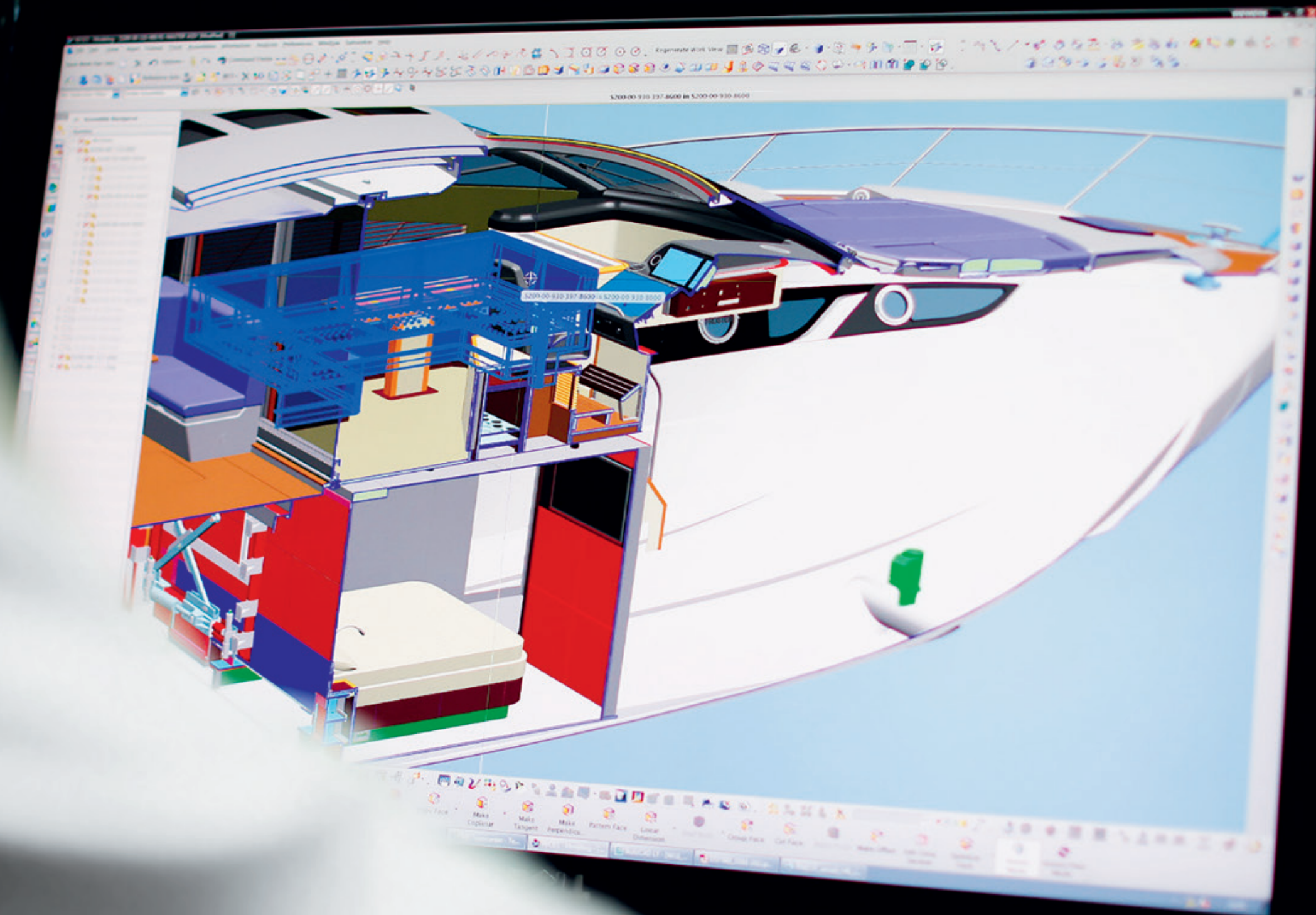

THROUGH INNOVATION COMES EXHILARATION

Intelligent innovation is the philosophy that rules everything we create.

It is why we have become the only manufacturer to produce a luxury yacht range from 50 to 155ft under one name.

Our in-house design team, still steadfastly guided by John Braithwaite, is at the vanguard of marine design, technology and engineering excellence.

It is a dream team with the incomparable vision, confidence and skill to continually innovate our boat design – to create ever more thrilling experiences and adventures. Invention for inspiration.

It is the simple reason why customers the world over await the next Sunseeker with such anticipation.

Because the world knows every new Sunseeker promises innovation that truly exhilarates.



100 OVER 100^{FT}

It is a landmark that signals a bold new age for Sunseeker.

A milestone that measures the sheer breadth of our range of exceptional yachts, built upon a heritage of innovation and craftsmanship spanning 50 years.

On 9 September 2015, we held an exclusive celebration at Cannes Yachting Festival to recognise the delivery of our 100th luxury performance yacht in the 100ft+ superyacht category.

It was summer 2000 that we first launched a model over 100ft long – the unforgettable 105 Yacht, which went on to win two of the world's most prestigious accolades in the International Superyacht Design awards. It was the first step in our journey to become a major player in the superyacht sector.

Amazingly, it has taken just 15 years to reach our newest milestone.

Today, we produce around seven 100ft+ yachts every year. Our range now encompasses boats from the powerful 101 Sport Yacht to the majestic flagship 155 Yacht, with a world of bespoke options in between.

And of course we're always seeking more. With each new creation, a new best is born. Blending cutting-edge technology with traditional handcraft to create yachts that inspire and delight.

96'

97'

98'

99'

101'

102'

103'

104'



EXCEPTIONAL CRAFT, PROUDLY HANDCRAFTED

A hawk's eye, expert hands and a devilish attention to detail.

Passed from generation to generation, these are the most important skills required to make a Sunseeker.

In an age of digital production and automated assembly, we stay committed to creating hand-built, hand-finished boats – for one simple reason.

There is no better way to craft such an exceptional product.

Inside and out, the extraordinary detail, finish and sheer artistry of our yachts can only be achieved by human qualities.

And, most importantly, no machine can ever give our boats such spirit, or take such pride in their creation – a vitality passed on to every owner.



MAKE IT YOUR SIGNATURE

Your signature is truly unique.

No-one else has one quite the same. And so it should be with your very own Sunseeker.

Which is why we have our truly unique Bespoke service, offered for yachts 100ft and above. It offers you something truly unique. A blank sheet of paper for you to create a yacht personalised in any way you wish.

From floor plans to unique furnishings, your imagination and passion can be fully expressed.

With some of Britain's finest in-house interior designers at your side, you can choose materials, fabrics and finishes to reflect your unique desires and individuality.

To give your Sunseeker something no-one else can. Your signature.

Bespoke



SAN REMO

Length overall (Fixed Platform)	15.74m	51'8"
Length overall (Lifting Platform)	16.17m	53'1"
Beam	4.30m	14'1"
Draft	1.3m	4'3"
Displacement	16,566kg	36,522lb
Fuel capacity	1,320 litres	349 US gal.
Fresh water capacity	322 litres	85 US gal.
Accommodation	Up to 4 + 1 guests	
Engine options	Twin Volvo Penta IPS 600 (2 x 435PS)	
Performance	Up to 30 knots	
Range	Up to 300 nautical miles	
Drives	Pod drives	





GENERAL ARRANGEMENTS

SAN REMO



SIDE PROFILE

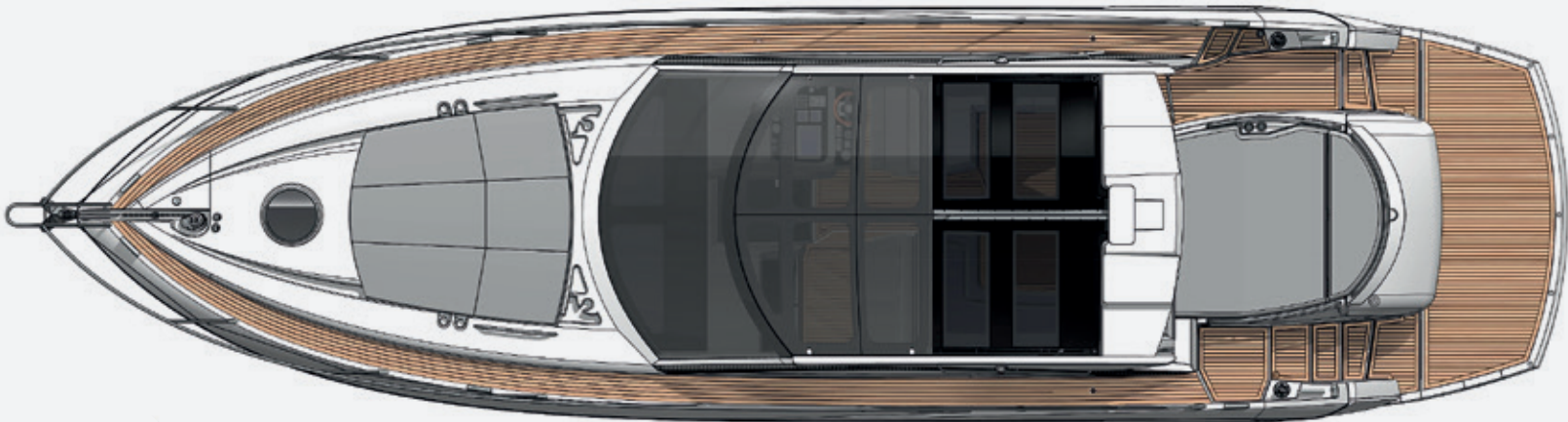

EXTERIOR PLAN
Shown with optional teak side decking

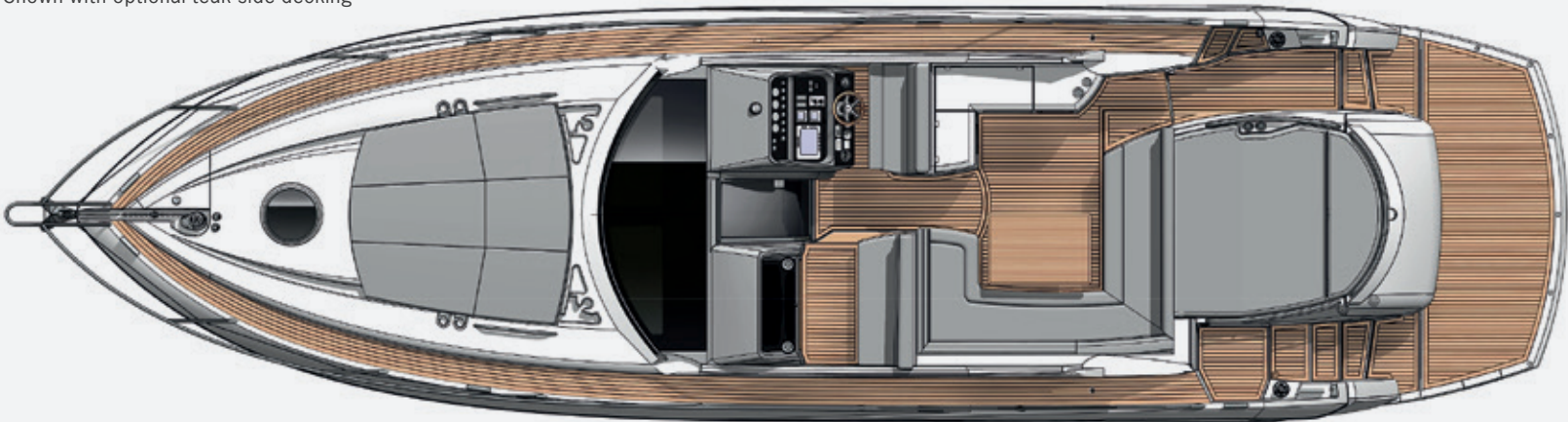

MAIN DECK
Shown with optional teak side decking

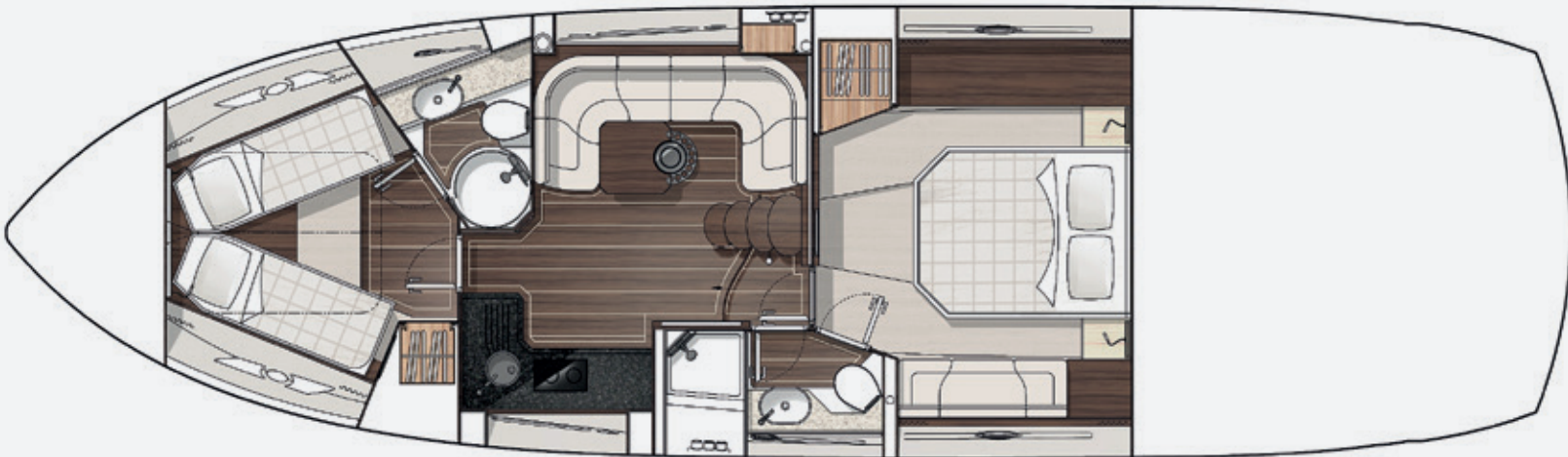

LOWER DECK

STANDARD
SPECIFICATIONS

1 Construction Hand-laid GRP Gel coat including stripes Vinylester skin coat with powderbound mat Stitched multi-axial reinforced single-skin bottom Balsa-cored hull topsides PVC foam-cored deck and superstructure Hull stiffened with longitudinal stringers supported by transverse bulkheads and floors Antifouling	Folding teak helm seat Co-pilot seating area Chart table Large stern sunbather over garage space Glass holders Overhead cockpit lights 12v Low-level cockpit lights 12v	Scatter cushions Fitted carpet Wooden steps	Stowage cupboard Electric toilet Shower compartment Overhead lights Opening porthole with mosquito screen and curtain Razor socket 240/110v	11 Engine Compartment and Ancillaries Soundproofing throughout Fuel filters/water separator to engines and generators FM200 manual/auto fire exit system Automatic bilge & flood pumps with high-level alarms Air-extraction fans – 24v Generator exhaust silencers and water separators Engine exhaust dry risers and water injection Strainers to all raw water materials	14 Systems Electric toilet system – 24v Aluminium freshwater tank GRP fuel tank Freshwater pressure system – 24v Calorifier – 240v Grey water stump box and discharge pump – 24v Bilge pump system FM200 manual/auto fire exit system Auxiliary hydraulics Hydraulic power steering
2 Deck Moulded non-slip deck finish Fittings all in stainless steel Pulpit and cockpit rails Stainless steel fendering with rubber insert 8 stainless steel cleats Electric anchor winch and capstan with deck and cockpit controls Stainless steel bow roller with anchor stop Delta anchor and 30 metre chain (galvanised) Chain locker with fender storage IMCO navigation lights Fuel filler Fresh water filler Foldaway swimming ladder Teak-laid bathing platform and steps Hot and cold swimming shower Ensign staff and socket Fender tie bar under anchor locker lid	4 Helm Console Console with burr-type walnut fascia Radar Autopilot VHF radio Leather and chrome steering wheel Single lever controls Full analogue engine instrumentation Speed and depth sounder display Fuel gauge Fresh water gauge Compass Horn Trim tab controls Waterproof plug and socket 2 windscreen wipers and washers Fire extinguisher Glass holders	6 Galley Electric refrigerator Electric twin hob Microwave Hot and cold water 6 place crockery set 6 place cutlery set Cupboard storage and drawers Opening porthole with mosquito screen and blind Double AC socket Hand-held fire extinguisher First aid kit Rubbish bin	9 Twin Forward Cabin Two single V berths to swing and make double Under-berth storage Hanging wardrobe Storage cupboard Deck hatch Overhead halogen lighting 2 x reading lights Opening portholes within panoramic windows with mosquito screens Double AC socket Flatscreen television 22” DVD/CD/radio with stereo speakers Fitted carpet	12 Electrical System Slow speed generator with underwater silent exhaust system AC dockside connection Galvanic isolator 24v DC electrical system with full circuit breaker protection 4 x engine batteries 4 x domestic batteries 2 x generator batteries Alternator split-charging system Battery switches controlled from locker in cockpit Battery charger Water heater AC sockets throughout the boat	15 Miscellaneous 2 sets towels 2 x mooring warps 6 x fenders
3 Cockpit Teak cockpit sole, steps and platform Self-draining Safety door Full wetbar with hot and cold water and cool-box Dinette seating Teak table	5 Main Cabin/Saloon Large folding dinette Flatscreen television 32” DVD/Blu-ray/radio 2:1 sound system Radio/CD with speakers for the cockpit Stowage beneath seats Drinks cupboard Overhead halogen lights 12v Opening portholes within panoramic windows with mosquito screens and blinds Deck hatch Main switch and circuit breaker panel (AC/DC) Double AC socket Choice of interior finishes and veneers	7 Master Aft Stateroom Double bed Storage lockers 2 x reading lights 12v Hanging wardrobe Overhead halogen lighting Large side windows and blinds Settee Door to toilet/shower Two double AC socket Flatscreen television 32” DVD/CD/radio with stereo speakers Fitted carpet	10 En Suite Toilet Compartment Washbasin Taps and accessories Hot and cold water Mirrored vanity unit Toothbrush glass holder Soap dish Towel ring Shower Overhead lights Electric toilet Opening porthole with mosquito screen and curtain Razor socket 240/110v	Optional Extras Air conditioning Upgraded generator Bow thruster Hydraulic lifting platform – maximum capacity for platform and garage combined 350kg/772lb	
		8 Master En Suite Toilet Compartment Washbasin Taps and accessories Hot and cold water Mirrored vanity unit Toothbrush glass holder Soap dish Towel ring		13 Underwater Gear Volvo Penta IPS drive system Valves to all underwater skin fittings Sea water strainers to engines and generators Full cathodic bonding system to zinc anodes Stainless steel trim tabs	



AWARDS AND ACHIEVEMENTS

2015

ASIA BOATING AWARDS
Best Brand Presence

2014

WORLD YACHT TROPHIES
101 Sport Yacht – ‘Best Exterior Design’

ASIA BOATING AWARDS
Predator 80 – Best Worldwide Production Motoryacht 15M–24M

WORLD SUPERYACHT AWARDS
40 Metre Yacht ‘Sea Raider V’ – Finalist

2013

ASIA BOATING AWARDS
Best Brand Presence

MOTOR BOAT OF THE YEAR AWARD
28 Metre Yacht – ‘Best Custom Yacht’

2012

MOTORBOAT & YACHTING AWARDS
Manhattan 63 – ‘Best Flybridge above 55ft’

ROBB REPORT CHINA
‘Best of the Best’ 28 Metre Yacht

ASIA BOATING AWARDS
28 Metre Yacht – Best Production Motoryacht 24M–40M

WORLD SUPERYACHT AWARDS
Predator 130 ‘Never Say Never’ – Finalist

2011

ASIA BOAT AWARDS
Best Brand Presence in Asia

EUROPEAN CEO CORPORATE LIFESTYLE AWARDS
Best Luxury Brand

SHOWBOATS DESIGN AWARDS FLORIDA
Naval Architecture Motoryacht ‘Evil Zana’ Predator 130

2010

WORLD SUPERYACHT AWARDS
Predator 130 ‘Evil Zana’ – Finalist

QUINTESENTIALLY AWARDS
Yacht Charter of the Year

SYDNEY BOAT SHOW
Boating Industry Association of NSW – Best Marina Display

SYDNEY BOAT SHOW
Boating Industry Association of NSW – Best Overall Display

ASIA BOATING AWARDS
Predator 60 – Best Production Motoryacht 51 to 80 feet

2009

SYDNEY BOAT SHOW
Display of Excellence

CROATIA BOAT SHOW
Predator 92 Sport – Best in Class

CROATIA BOAT SHOW
30 Metre Yacht – Best in Class

CROATIA BOAT SHOW
Best Boat Show Stand

2008

UK MOTOR BOAT OF THE YEAR AWARDS
Manhattan 60

2007

EUROPEAN POWERBOAT OF THE YEAR
Superhawk 43

ASIA PACIFIC BOATING AWARDS
90 Yacht, Best of the Best

MODERN BOATING MAGAZINE
Portofino 47, Imported Powerboat of the Year

AUSTRALIAN MARINE INDUSTRIES FEDERATION AWARDS
Predator 62, Imported Powerboat of the Year

NOMINATED BY THE SUPERYACHT SOCIETY
37 Metre Yacht ‘The Snapper’

QUEEN’S AWARD FOR ENTERPRISE
International Trade

ROBERT BRAITHWAITE IS HONOURED WITH CBE
The Queen’s Birthday Honours List

2006

NOMINATED FOR THREE SUPERYACHT AWARDS
Predator 108 ‘SHIVER’

2005

AUSTRALIAN MARINE INDUSTRIES FEDERATION AWARDS
75 Yacht, Non-Trailable Boat Award

AUSTRALIAN MARINE INDUSTRIES FEDERATION AWARDS
Portofino 46, Commendation

MODERN BOATING, POWER BOAT OF THE YEAR AWARDS
Predator 68, Imported Powerboat of the Year

BOATS.COM MARINE INDUSTRY WEB AWARDS
Manufacturers Category for www.sunseeker.com

2004

SYDNEY BOAT SHOW
Best Overall Display

SYDNEY BOAT SHOW
Best Marina Display

2003

AUSTRALIAN MARINE AWARDS
Manhattan 56, Award for Excellence

AUSTRALIAN MARINE AWARDS
Predator 68, Best Imported Non-Trailable Yacht

2002

ENTREPRENEUR OF THE YEAR AWARD
Robert Braithwaite MBE

2001

BEST POWER DESIGN AWARD
105 Yacht, The Superyacht Society

BEST POWER INTERIOR AWARD
105 Yacht, The Superyacht Society

PRESIDENT’S AWARD
Southern California Marine Association

2000

QUEEN’S AWARD FOR ENTERPRISE
Continuous Innovation and Development

THE TIMES EXPORTER OF THE YEAR
Times Export Awards

ROBB REPORT AWARD
Best of the Best, Boating and Sailing

1999

ROBB REPORT AWARD
Best of the Best, Boating and Sailing

MOTORBOAT OF THE YEAR
Predator 75, BT British Nautical Awards

1998

SUPERYACHT DESIGN AWARD
Manhattan 74, Superyacht Design Awards

EDITOR IN CHIEF AWARDS
Yachts Magazine

1997

LIFETIME ACHIEVEMENT AWARD
Robert Braithwaite MBE, RYA Awards

1996

MOTORCRUISER OF THE YEAR AWARD
RYA British Nautical Awards

EXPORTER OF THE YEAR AWARD
DCCI Export Awards

1995

BOAT BUILDER OF THE YEAR AWARD
RYA/BMIF British Nautical Awards

1994

QUEEN’S AWARD FOR EXPORT ACHIEVEMENT
Queen’s Awards for Industry

1992

BEST IN THE WORLD AWARD
Renegade 60, Boating Magazine

ROBERT BRAITHWAITE IS HONOURED
WITH MBE
The Queen’s Birthday Honours List

1990

EXPORTER OF THE YEAR
SW International Business Awards

1989

QUEEN’S AWARD FOR EXPORT ACHIEVEMENT
Queen’s Awards for Industry

1987

QUEEN’S AWARD FOR EXPORT ACHIEVEMENT
Queen’s Awards for Industry

ACKNOWLEDGEMENTS

PHOTOGRAPHERS:

Tom Benson
Quin Bisset
Martin Brent
Jeff Brown
Andy Cahill
Gary Castle
Joe McCarthy
Ian Winstanley

CLOTHING & ACCESSORIES:

Roja Dove
Hansgrohe
Haviland
Heirlooms
Jo Malone
Milena M.
Tresor Paris
Porta Romana
SEABOB
Itsomi Sotogrande
Williams Jet Tenders

