



## Azimut 50 | 2017

New yacht

Price in Europe

**1 042 800 €**

VAT excluded

### Short description

### Specifications

Length overall	15.88 m
Beam overall	5.00 m
Draft	1.52 m
Material	GRP
Cabines	3 + 1
Head compartments	2 + 1
Engine	2 x Volvo Penta D11 670 mHP
Fuel capacity	2200 l
Water capacity	590 l
Max speed	32.00 knots
Cruising speed	26.00 knots
Range	290 miles



Exterior Azimut Flybridge 50



Exterior Azimut Flybridge 50



Exterior Azimut Flybridge 50



Exterior Azimut Flybridge 50



Exterior Azimut Flybridge 50



Bow deck





Swim platform



Swim platform



The flybridge



The flybridge



The flybridge



Helm station on the flybridge



Wheelhouse



Galley UP



Galley



Salon



Galley

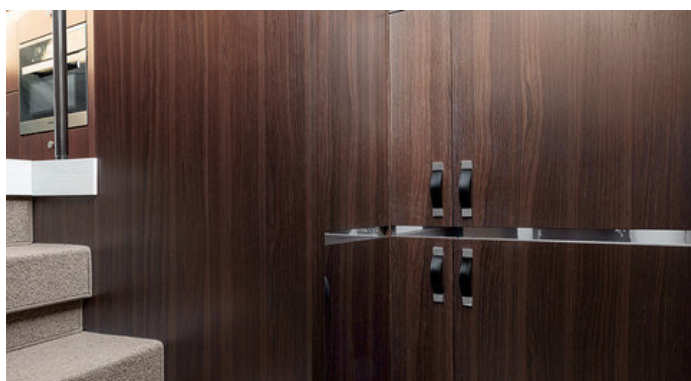

Lower deck





Galley Down



The salon on the main deck



Salon



The salon on the main deck



Kitchen set



The owner's cabin



The owner's cabin



The owner's cabin



Bathroom in the master cabin



VIP stateroom (bow)



Guest cabin



Guest cabin (left) and bathroom VIP and guest cabins (on the right)



### Flybridge

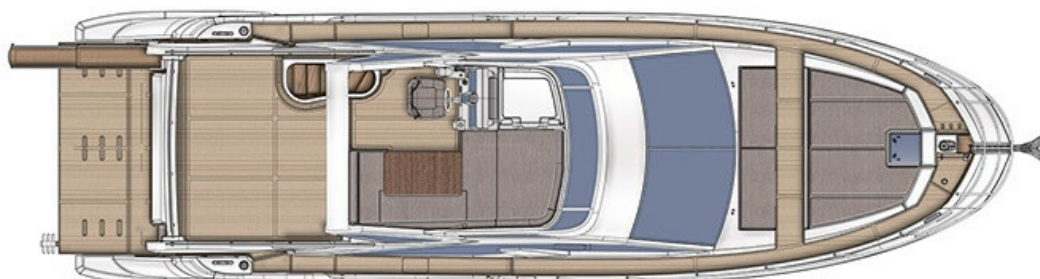

### Main deck (Galley UP)



### Lower deck (Galley UP)

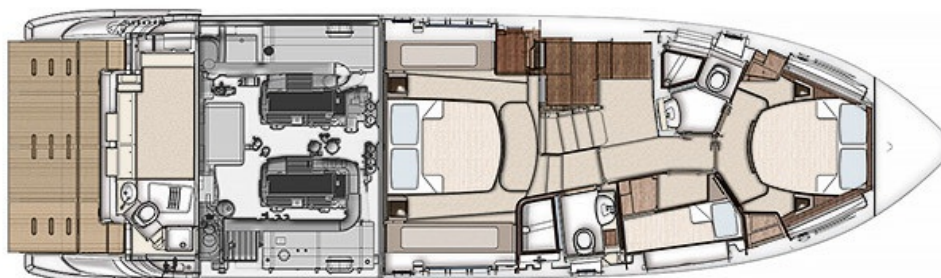

## Technical characteristics

Length overall	15.88 m	Range	290 nm
Beam overall	5.00 m	Fuel capacity	2200 l
Draft	1.52 m	Water capacity	590 l
Displacement	5.2 t	Cabins	3 + 1
Engine	2 x Volvo Penta D11 670 mHP	Berths	6 + 1
Max speed	32.00 knots	Head compartments	2 + 1
Cruising speed	26.00 knots	Material	GRP
		Interior design	Carlo Galeazzi
		Builder	Stefano Righini

### Regulations UNI ISO 8666

The levels of performance described apply to a standard craft (with standard equipment installed) with clean hull, propeller and rudders. Moreover, it is specified that such levels of performance were achieved under favourable sea and wind conditions (1 on the Beaufort scale and 1 on the Douglas scale); in the case of diverse or less favourable sea conditions performance levels may vary considerably.

### EC Approved

Azimut reserves the right to modify the specification and characteristics of its vessels at any time.

## Standard specification

### Engines

- Manufacturer VOLVO Penta
- Model D11 - 670 mHp
- Type Diesel engine
- Max. power 2x 493 kW

### Reduction gears/marine gears

- Manufacturer ZF
- Model 325-1 IV
- Reduction ratio 1:2037

### Transmission

- Configuration Shaft line
- Shaft length 3,126 mm
- Shaft angle 11°
- Shaft diameter 55 mm
- Distance between centers 1,400 mm
- Building material DUPLEX STEEL
- Shaft supports in satin brass
- Hull casing diam. 55

### Propellers

- Model 4 blades
- Building material NiBrAl
- Diameter 740 mm



- Pitch 1,000 mm
- Profile C-foil

#### Steering system

- Rudders made of stainless steel

#### Flybridge

- Accessible from the outside, cockpit stairs, port side
- GRP cockpit stairs with 6 non-slip (knurled) steps
- GRP external steps with non-slip (knurled) sections
- Non-slip floor
- Access door
- Smoked Plexiglas flybridge screen with stainless steel and aluminum frame
- GRP radar arch
- Handrail: NMMA compliant stainless steel (tube 30 X 2) (stern flybridge handrail, flybridge access protection handrail, flybridge life rail, mobile flybridge handrail)
- Fore sunbed area
- Helm seat for 1 person
- Adjustable steering wheel (4-spoke steering wheel white painted)
- C-shaped sofa connected to sunbed area
- Table with central stainless steel leg
- 1 bow locker (in front of dashboard)
- 1 locker under bench, starboard side
- Manual depth searchlight
- Stainless steel light mast
- Flybridge dashboard consisting of:
  - - 1 engine display
  - - BRONZE series electronic navigation instruments
  - - Engine start-up controls
  - - Bow anchor winch controls
  - - horn controls
  - - Interceptor control
  - - Flybridge bilge controls
  - - 12V socket
  - - Chain meter counter
- Scuppers with stainless steel grids
- "50" logos, placed externally on the radar arch glass, one on each side
- Azimut logos, placed externally on the tails of the GRP superstructure, one on each side

#### Bow / walk arounds

- Anchor chain and fender locker with water drainage
- DELTA 25kg galvanized steel anchor
- 75 m long high strength 10 mm gaged chain
- 2000 W winch
- 2 stainless steel cleats L. 300 mm oval tube
- Sunbed area with non-slip finish
- Chain washing pump
- Non-slip floor
- Scuppers with stainless steel grids
- Forward facing sofa with 4 seats, including cushions for seats and backrest

#### Walk arounds

- Refueling: 2 "Diesel" refueling plugs diam. 88 mm with cover
- Fresh water filling: 1 "Water" refill plug, diam. 85 mm
- Black water outlet: 1 "Waste" outlet water plug diam. 75 mm without cover
- 2 stainless steel cleats L. 300 mm oval tube (intermediate)
- Non-slip floor
- Pulpit with handrail D:35 mm, thickness 2 mm
- Rub-rail: in stainless steel and high resistance PVC

## Cockpit and platform

- Double cockpit access via stainless steel and Plexiglas gate
- 2 stainless steel cleats, H.110mm L.350mm
- 2 handrails (RH and LH) on the side of the deckhouse
- Mooring station: dim. 1230X210
- Aft stainless steel left/right chock
- Door with steel frame, aluminum panels, flat glass
- 4-seater C-shaped cockpit bench (in GRP integrated in the deck)
- Cockpit bench cushions
- 1 locker under cockpit bench, LH side
- 1 port deckhouse column locker
- Lockers below cleat (one each side)
- RH locker with battery cut-out
- Engine room access via door in cockpit floor
- Crew cabin access via hatch in cockpit bench
- Non-slip floor
- Flybridge access stairs handrail
- 2 loudspeakers
- Lighting: spotlights in cockpit ceiling panel
- Scuppers with stainless steel grids

## Platform

- Hydraulic platform
- Stern platform lights
- Non-slip floor
- Swimming ladder
- Hot and cold water shower head
- INSTALLABLE TENDER:
  - - WORKING DIMENSIONS OF PLATFORM: 3.5x1.13 m
  - - System max. net capacity (SYMMETRICAL): 700 kg (excluding platform)
  - - Max. permitted capacity (asymmetrical): 380 kg (including platform)
  - - HYPOTHETICAL PLATFORM TENDER: 3.2x 1.5 m.
  - - HYPOTHETICAL WILLIAMS TENDER: WILLIAMS Turbo Jet285

## Wheelhouse

- Single helm seat
- Cupboard under helm seat in heat-treated oak
- Manually operated window
- Leather adjustable steering wheel with stainless steel spokes
- Dashboard consisting of:
  - - BRONZE series electronic navigation instruments
  - - Communication systems (VHF) Electronic remote controls CRUISE COMMAND
  - - Magnetic compass
  - - Interceptor switches
  - - Interceptor indicators
  - - Horn, navigation lights, wiper switches
  - - Activation of bilge pumps
  - - Emptying of black and gray water tanks
  - - Engine room ventilation
  - - 12V socket
  - - Shore power socket indicator light
  - - Chain washing pump switch
  - - Diesel tank, black water, gray water, and fresh water level gage on Raymarine display
- Engine control instruments:
  - - multifunction display for controlling the Volvo Penta engines
  - - engine start-up buttons
  - - alarm indicator lights

## Saloon / Galley



- Cupboards in heat-treated oak
- Carpeted floor
- 1 2-seater sofa on port side
- 1 4-seater C-shaped sofa on starboard side
- Glass fronted cabinet for crockery
- Provision for TV system with aerial
- Ceiling coated with white color leatherette
- Walls coated in dark brown leatherette
- Roman blinds for stern windows and sliding blind for saloon door
- 2 loudspeakers
- Saloon table with stainless steel leg

#### Galley

- Laminated floor
- Steel divider with plexi bencore kaos
- Port side electric window
- Ceramic glass range with 4 hobs
- Stainless steel extractor hood
- Stainless steel sink
- Refrigerator/freezer(180 liters)
- Microwave oven + grill
- Storage compartment accessible from above

#### Storage

##### Located on port side of the stairway

- Carpeted floor
- Storage cupboards in heat-treated oak
- Handrail
- Wooden-fabric coating

#### Corridor

- Carpeted below deck access
- Spotlights
- Fabric bulwark upholstery
- Corridor grabrails

#### Owner's cabin

- Located midship
- Double bed placed in the center astern with headboard
- 2 fixed bedside tables
- Cabinets with doors and shelves on both sides
- Wardrobe with hanger bar on port side
- wardrobe with shelves in front of bed
- Spotlights
- 2 openable portlights
- Hull windows with 3 frames
- Direct access to the head from the corridor leading to the owner's cabin with internal stairs
- 1 mirror in wardrobe
- Metal Venetian blinds
- Fabric wall upholstery and wood paneling
- Fabric ceiling panels + some areas in gelcoat
- Provision for TV system
- Sockets
- Air conditioning system control panel (if A/C installed)

#### Owner's head

- Located forward of the owner's cabin, on starboard side
- Access from owner's cabin
- GRP top and cognac (brown) colored Vetro Freddo washbasin

- TECMA toilet
- Chromed mixertaps
- Separate shower enclosure; flat shower door
- Chromed shower rail
- Wall unit with 1 openable door next to washbasin top and underbasin cabinet with shelves
- Spotlights
- 1 openable portlight
- Metal Venetian blinds
- Non-slip GRP flooring in shower
- Sockets
- Head accessories
- Head air extractor: forced extraction (from the shower ceiling panel)

#### Starboard side guest cabin

- 2 fixed bunk beds
- 1 bedside table next to beds
- 1 wardrobe with coat rack and shelves
- Lockers under bed
- Fabric ceiling panel + some areas in gelcoat
- Fabric bulwark upholstery
- Openable round portlight
- Metal Venetian blinds
- Carpeted floor
- Spotlights
- Access to head leading to corridor
- Sockets
- Air conditioning system control panel (if A/C installed)

#### Guest / VIP head

- Positioned abaft of the VIP cabin, on port side
- Washbasin with GRP top
- Direct access from the VIP cabin or from the corridor
- GRP top and cognac (brown) colored Vetro Freddo washbasin
- Chromed mixertap
- TECMA toilet
- Separate shower enclosure with glass door
- Chromed shower rail
- Spotlights
- Underbasin cabinet with shelves
- Metal Venetian blinds
- Non-slip GRP flooring in shower
- Head air extractor: forced extraction (from the shower ceiling panel)
- Head accessories
- Openable round portlight
- Socket

#### VIP cabin

- Located towards the bow, it is accessed via a central corridor
- Foldaway double bed with large locker underneath
- Wooden headboard + white leatherette insert
- 2 openable wall units with 2 storage areas (each side) over the windows
- 1 wardrobe on the starboard stern wall with hanger bar
- 1 wardrobe on the port stern wall with shelves
- Fabric ceiling panel + some areas in gelcoat.
- Spotlights
- Emergency exit in ceiling through concealed rectangular hatchway leading to fore sunbed area
- Direct access to guest head
- Mirror inside wardrobe
- 2 openable round portlights inserted in windows
- Metal Venetian blinds



- Fabric-upholstered bulwarks and ceiling
- Carpeted floor
- Air conditioning system control panel (if A/C installed)
- Sockets

#### **Crew room (OPT)**

##### **Crew cabin**

- Located at stern
- Access from cockpit bench
- Single bed with under-bed compartments
- 1 wall unit
- 1 wardrobe
- 1 head cabinet
- Fabric bulwark upholstery
- GRP ceiling + upholstered panels
- Bulwark shelves, 1 at the foot of the bed, 1 over the rudder hold
- Openable round portlight with 250 mm. dia. over cockpit bench
- GRP non-slip floor
- Spotlights
- Fabric blind

##### **Crew quarters**

- TECMA toilet
- White resin washbasin
- Chrome mixer with extractable shower head
- Shower area with waterproof curtain
- Wall unit with mirror
- Under sink door
- Power socket
- Head accessories

#### **Electric system**

##### **Main characteristics**

- Shore-powered power supply
- Onboard voltages:
  - - 230V- 50Hz AC
  - - 24V DC from battery set
  - - 12V DC for VHF equipment and cigarette lighter socket
- The main boards are in the wheelhouse, engine room and crew area
- The power circuit breakers that protect the instrument panel, engine controls, navigation instruments and shore power socket and generator selector switches are located in the wheelhouse.
- Other power circuit breakers that protect the various 24V DC and 220V AC utilities are located under the wheelhouse and are protected by a cover.
- Additional circuit breakers are located on the main panels in engine room to protect the various 24V DC utilities and the 230V AC utilities in the crew area
- Junction boxes are installed in all areas

##### **Galvanic current insulation**

- zinc anodes

##### **Generator**

- 1 3.5Kw 230V 50Hz standard generator in engine room

##### **Shore power sockets**

- 1 50A socket astern
- 1 for air conditioning (OPT)

##### **Batteries**

- Services: 6 AGM type batteries, 270Ah 24V DC

- Engines: 4 AGM type batteries, 180Ah 24V DC
- Generator: 1 AGM type battery, 70Ah 12V
- 24V battery charger: 24/60 3 Out- 60A- 10A-10°
- 12V battery charger: 12/15 2 Out-15°

#### Lights and sockets

- AC sockets: 230V for main utility power supply, EU type
- DC sockets: cigarette lighter type (wheelhouse)
- 24V lighting (halogen for outside and LED for inside)
- 24V external lights

#### Electronic navigation instruments

- For STD equipment, see "flybridge dashboard equipment" and "internal dashboard equipment" paragraphs
- For a detailed list of alternative/additional equipment available, please refer to the Optionals price list

The electronics are constantly being updated, therefore the indicated configuration may be subject to changes.

#### Bilge system

- 3 24V electric pumps(crew cabin, engine room, owner's cabin) automatically operated by means of level switch + wheelhouse controls
- 2 manual emergency pumps; 1 owner's cabin and 1 inside cockpit's starboard locker
- 1 Supersub Smart 650 24 V electric bilge pump, 24 l/min
- Level alarms in wheelhouse
- Rapid engine room emptying connected to port engine seawater system

#### Fire extinguishing system

- Handle in cockpit starboard side and emergency pushbutton on emergency panel
- 1 12 kg homologated cylinder with nozzles above the engines
- Fuel delivery shut-off to engines and generators

#### Fuel system

- 2 aluminum tanks in engine room with a capacity of 1100 l and a total capacity of 2200 l
- Electronic fuel gage on port tank
- Optical fuel gage on starboard tank
- Single settling filters for engines
- 1 filter for generator
- 2 refueling plugs on walk arounds
- 2 vents on bulwark
- Remote diesel shut-off (engine and generator) via 24V solenoid valve
- Pipe connecting the two tanks to adjust the fuel level
- Fuel drawing tap on starboard tank

#### Fresh water system

- 590 l polyethylene tank located under the bed in owner's cabin
- Water refilling on starboard walkaround
- Level sensor with electronic gage in wheelhouse
- 1 tank vent on starboard bulwark
- 1 water pressure pump with electronic control
- 1 water heater, 40 l
- Stern shore power socket on port side
- Hot/cold water line: heads, galley, cockpit, bathing platform shower head; Cold water only in flybridge washbasin; cold water only in engine room
- Fresh water toilet flushing
- System that can be isolated by ACORN manifolds, located under the owner's head cupboard
- Toilet fresh water supply

#### Black water system

- 175 l polyethylene tank located under the floor in the galley/corridor
- Level sensor with gage in wheelhouse
- 1 tank vent on starboard bulwark with anti-odor filter
- MANUAL pump operating switch with control switch in the wheelhouse
- 1 macerator pump, 341/min
- Suction point from starboard walk around



- Outboard discharge
- Tecma toilet (with macerator pump). All toilets discharge into a tank

#### Gray water system

- 175 l polyethylene tank located under accommodation corridor
- Tank vent on port bulwark
- Level sensor with gage in wheelhouse
- Outboard discharge through pump
- MAN/AUTO pump operating switch with control switch in the wheelhouse
- Three-way valve in galley for deciding whether to discharge into the sea or in the tank
- 1 pump 26 l/min
- Collection tray with built-in pump with outboard discharge, under crew tray

#### Seawater system

- Engine cooling system: includes 2 2" seawater intakes with filter and valve (1 per engine)
- Generator cooling system: includes 1 1" seawater intake with filter and valve
- Air conditioning cooling system: 1 1" seawater intake with filter and valve
- Chain washing pump: 1 1/2" seawater intake with filter and valve 1 remote

#### Ventilation/extraction

- Head ventilation: forced extraction by way of 24V extractors
- Engine room:
  - - Natural air intake through air duct with water separator (1 each side)
  - - Forced ventilation: 2 24V extractors (1 each side)

#### Other systems

- Steering system: hydraulic power steering with 2 round profile rudders.
- Interceptor system (Zipwake).

#### Air conditioning system (OPT)

- Water-based system, WORLD version
- 1 compressor in engine room (60,000 total BTU)
- 1 seawater pump with relevant intake
- Each area has its own control panel making it independent

#### Equipment

- 1 telescopic boat hook
- 5 anchor lines
- 18 m fender lines
- 1 anchor chain stopper
- 6 fenders
- 6 black fender covers
- 1 Owner's Manual
- 1 AZIMUT document holder
- 1 wooden model of the boat
- 1 AZIMUT warranty service booklet
- 3 float key-rings
- 1 bag (with logo) for storing the manuals
- 1 remote control holder (with logo)
- 1 routine maintenance kit for steel
- 1 pin wrench for locking stainless steel pins

## Installed options

---

#### Advance Package

- Potholder
- External covers package (mesh covers for windows and windscreen, covers for fly and cockpit furnitures)
- Onan 13,5 kw Generator



Offer generating date 05.03.2020

- Bow Thruster
- Decor 5\*
- Automatic Fire Fighting system
- Air Conditioning BTU 60.000
- Additional searchlight control at lower helm
- Electric searchlight
- Double Racor filters for main engines
- Chaincounter control at main helm
- Electric mooring winches in cockpit
- Easy Docking manouvering joystick for engines and thrusters (Xenta)
- Racor filter for generator
- Shore water plug
- Miele appliances (microwave combo and cooktop)
- Spare conduits connecting engine room/wheelhouse/radar arch
- Water maker Predisposition (salt water - fresh water - electrical)

#### Optionals

- Teak deck on swim platform
- Raymarine AIS 650
- Telescopic gangway opacmare 2,71m
- Dimmers in salon and lower deck
- Hi-lo system for TV - (TV not included )
- Raymarine Gold Package(Fly: 2 x chartplotter Raymarine a125, RMK-9 remote control, Raymarine i70, p70R autopilot, Raymarine Open array HD 4kW 48" Color, VHF 2nd station; Main helm:2 x chartplotter Raymarine a125, RMK-9 remote control, Raymarine i70, p70R autopilot, VHF Ray260, SMART DST800 transducer in hull (depth / speed / temperature), HS-5 network switch, EV-1 autopilot sensor core, Raymarine VCM100 voltage converter module)
- Crew Cabin with air conditioning
- Teak on cockpit deck
- Washer dryer combo unit
- Sunbathing cushions on bow with foldable backrest in grey vynil fabric
- Dishwasher in galley
- Salon table with hi lo mechanism