



SPECIFICATION C330

PRINCIPAL DIMENSIONS *(According to ISO 8666)*

LOA	10.31 m	33' 10"
LH	9.99 m	32' 9"
Beam	3.50 m	11' 6"
Draught single engine	1.10 m	3' 7"
Draught double engine	0.90 m	2' 11"
Height above waterline inc. mast	3.37 m	11' 0"
Height above waterline excl. mast	2.77 m	9' 1"
Headroom minimum approx.	1.85 m	6' 0"
Fuel capacity	570 l	125 UK gal
Water capacity	220 l	48 UK gal
Displacement approx.	7100 kg	6.98 tn.l.
Max people on board	8	
CE Category	B	
ENGINE STANDARD		
1 x Volvo Penta D6 330 hp, Duoprop Sterndrive	25/26knots*	
ENGINE OPTIONS		
1 x Volvo Penta D6 400 hp, Duoprop Sterndrive	30/31 knots*	
2 x Volvo Penta D3 220 hp, Duoprop Sterndrive	30/31 knots*	



Main Deck

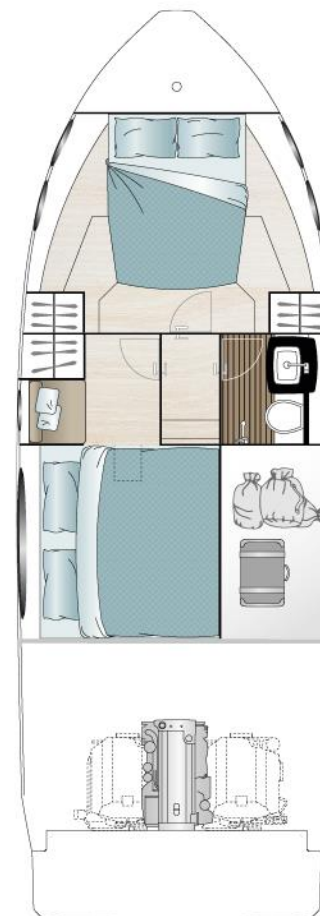

Lower Deck

*All performance figures are given in good faith and are intended as an indication. These figures cannot be guaranteed as top speed in particular is affected by the cleanliness of the hull, conditions of the propellers, weight carried and air/sea temperature. SEALINE reserves the right to change specifications in line with the company policy of improvement through research and development. Errors and omissions expected. Please check with your dealer for a full list of inclusions.

DECK

- Anchor Hauser Stainless steel
- Anchor locker, self draining
- Deck, moulding non-slip
- Fendering strip black rubber
- Fuel and water deck inlets
- Foredeck hatch for storage
- Navigation lights, full set
- Stainless steel pulpit rail, stainless steel top rail and wire below forward angled
- All cleats are stainless steel
- 4 mooring cleats
- One piece windscreen
- Recess for double bench with cupholders

COCKPIT AND BATHING PLATFORM

- Aft pillars in anthracite
- Engine room access with gas spring
- Ensign socket and staff
- Fuel shut-off valves
- Gas bottle locker with drain
- Handrails in stainless steel
- Cockpit Lighting
- Remote battery switches
- Sealine convertible fabric roof system at stern
- Seating, L-shaped sofa
- Storage lockers
- Bathing platform, self draining
- Stainless steel bathing ladder foldable
- Transom door to stb in stainless steel
- Foldable glass door to salon
- Tilting glass window to galley
- Transom shower with hot and cold water
- Wet bar with extendable wood top and storage underneath

HELM POSITION

- Compass
- Engine instrumentation
- Engine controls
- Fuel gauges
- Teak footrest at helm
- Helm seat with storage underneath
- Rudder angle indicator
- Socket, 12 V
- Steering wheel, fixed angle
- Screen demister

SALOON

- 2 roof hatches for ventilation
- Sockets, 230 V
- Storage lockers
- Table, fixed leg with insert glass holder
- Electrical control panel for 220 V AC and 12 V DC circuits
- Lighting, overhead
- Indirect lights (Led)
- Portholes
- Seating, L-shaped

GALLEY

- Cutlery drawer and tableware storage
- Galley working top with wood cover
- Fridge
- Lighting, overhead
- 1,5 Sinks, stainless steel with mixer taps
- Socket, 230 V
- Storage cupboards
- Stove, gas (2) burner
- Gas oven

FORWARD CABIN

- Berth, double with drawers underneath
- Skylight
- Deck hatch, opening
- Eye level shelving
- Lighting, overhead
- Indirect lighting
- Reading lights
- Shelf
- Portholes
- Socket, 230 V
- Wardrobe to port and starboard

AFT CABIN

- Berth double
- Lighting, overhead
- Porthole, (1) opening
- Socket, 230V
- Wardrobe to port
- Shelves
- Reading lights
- Seat accommodation to port
- Skylight

CABINS & DAY HEAD

- Hand basin with mixer tap
- Lighting, overhead
- Porthole, opening
- Shaver socket (230V)
- Shower drain with automatic pump
- Storage cupboard
- Toilet, manual

ELECTRICAL

- AC system, 230 V with shore support system
- Batteries - domestic 2 x 160 Ah
- Batteries for engine 1 x 95 Ah with link switch
- Battery charger, 50 amp
- Remote battery switches
- Hot water boiler 22 liters
- DC system, 12 V
- Fresh water pump
- Water gauge
- Windscreen wipers, (2) with screen wash

MECHANICAL

- Bilge pumps, automatic and manual
- Engine room with isolation
- Engine room fans
- Engine room light
- Fire extinguisher system, automatic and manual, in engine room
- Fuel tank
- Fuel filter for engine
- Steering, hydraulic (with standard single engine)
- Water tank
- Holding tank with deck outlet

DÉCOR

- Skylight, in bow and aft cabin
- Wood flooring
- Companionway steps with safety treads
- Door frames, in wood
- Furniture finished in ply wood with walnut style
- Galley counter tops in Bistro, frames in Corian®
- Toilet counter top
- Upholstery seating - from selection
- Convertible roof, Silver
- Dash, matt finish

- Mattresses

MISCELLANEOUS

- Hull white gelcoat
- Gelcoat waterline in black
- Identified locations for hand held fire extinguishers - hand held fire extinguishers are not supplied
- Sealine owner's manual in Sealine bag
- Salon side windows in transparent glass